

# DISPLAY OPERATION MANUAL



SCAN TO SEE OPERATION VIDEOS

READ THE MANUAL CAREFULLY BEFORE USE AND KEEP IT PROPERLY

- The scent diffuser can work with any work time you need.0:01-23:59 all day per week. And work density acceptable 5-300 seconds for continuous work / pause
- The machine can be set 5 different work time interval, it can set different working days, working times according to different requests and suit for different places.
- The machine can calculate automatically the remaining days of remaining oil on display after you set up bottle volume, oil volume, oil consumption and work time.
- The diffuser will change oil-light when oil volume is not enough
- The diffuser equips with some shortcut function to keep your setting in case someone else change it.
- The users need set up country time and work time when receive. then diffuser will work.
- The diffuser can stand alone, on wall, connect hvac system.
- The diffuser can stand alone, mount on wall, connect hvac system with part in package
- The users can set the bottle volume, current oil level and oil consumption,

## 1 Introduction - country time/work time; all button function

### 1) Country Time - Work time

Country Time

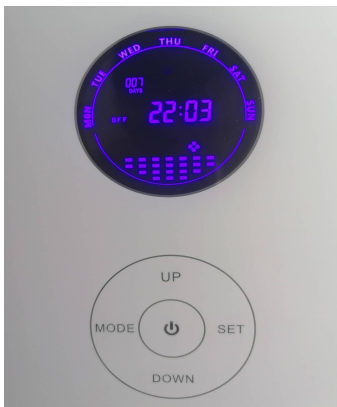

It shows when no touch display

Work Time



It will show when touch MODE button

### 2) Introduction for 4 button

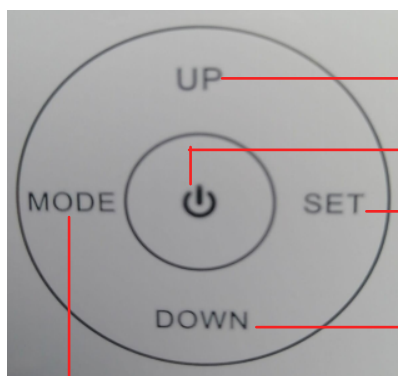

Increase Button

- After pressing SET button till Hour/Minutes/ day flash, then press UP button to adjust -

Turn off directly button  
- Press it quickly, diffuser will stop working directly-

Option Button

- When SET button till it flashes, then adjust by UP/DOWN button-

Reduce button

- After pressing SET button till Hour/Minutes/ day flash, then press DOWN button to adjust -

MODE Page

- When press MODE button, you can set up work time / pause time -

Note:

1. Diffuser only work when your country time is within work time

2. Please press SET button till Hour/minutes/ days flash If you want adjust, then adjust by pressing UP/DOWN button

## 2 SET UP COUNTRY TIME - (Include country time / bottle volume /oil volume / oil consumption)

When you receive diffuser, you need set up country time, if you come from New York. US. now New York time is 22:30, Tuesday.

### A. Set up Hour

*(change hour into 22)*



Step 1: press SET button till Hour flash



Step 2: press Down button till hour into 22

### B. Set up minutes

*(change minutes into 30)*



Step 3: press SET button till minutes flash



Step 4: press UP button till minutes into 30

### C. Set up day

*(change day into Tuesday)*



Step 5: press SET button till day flash



Step 6: press Up button till day into Tuesday

### D. Set up bottle volume

*(change bottle volume into 2000)*



Step 7: press SET button till above page show, this is bottle volume. Fixed Volume is 2000.



Step 8: press UP button till 2000 show

### E. Set up oil volume

*(change oil volume into 800ml if you have oil 800ml in bottle)*



Step 9: Press SET button till oil volume page show. it is oil volume in bottle. If have 800ml oil in bottle



Step 10: press UP button, adjust into 800

### F. Set up oil consumption

*(change oil consumption into 5)*



Step 11: press SET button till oil consumption page show. Fixed is 5ml/h



Step 12: press UP button, adjust into 5ml/h. then click SET button again to save setting

### 3 SET UP WORK TIME

Now let's show how to set up work time. for each work time, it includes start working time / stop working time/continuous work time / continuous pause time.on our diffuser,you can set up 5 work time interval as you need.

**Do example:** *If you want diffuser work from 9:20 am to 23:50. all days per week. continuous work 200 seconds, continuous pause 100 seconds.*

#### A. Set up start-working time

*(change into 9:20 All day)*



Step 1: press MODE button till "EVENT 1 on" page. means: start working time



Step 2: press SET button till hour flash



Step 3: press UP button,adjust hour into 9



Step 4: press SET button till minutes flash

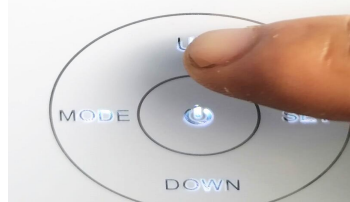

Step 5: press UP button to adjust into 20



Step 6: press SET button till day flash



Step 7: press UP button till day flash

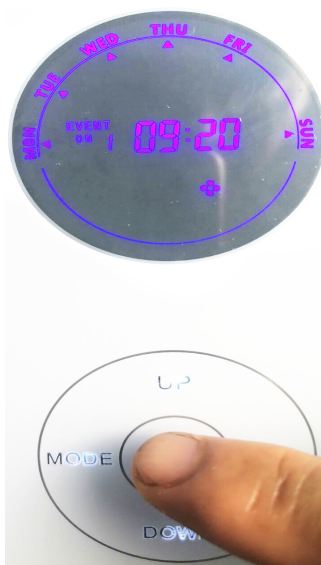

Step 8: click center button to save days you want add / remove

**B. Set up stop working time**  
*( change into 23:50 All day )*



Step 1: press MODE button till " EVENT 1 off", (stop working time )



Step 2: press SET button till hour flash

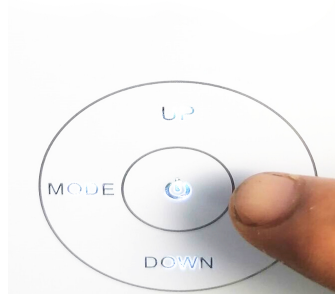

Step 3. press UP button to change into 23

Step 4. press SET button till minutes flash



Step 5. press UP button,adjust into 50

**C. Set up continuous work / pause time**

*( change continuous worktime into 200 seconds )*

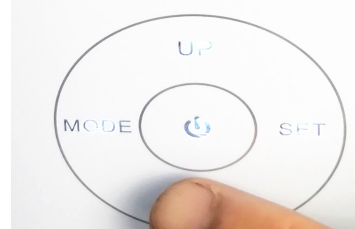

Step 1. press MODE button till " EVENT 1 Work" page show.(continuous work time )

Step 2: press DOWN button to adjust into 200

( change continuous  
pause time into 100  
seconds )

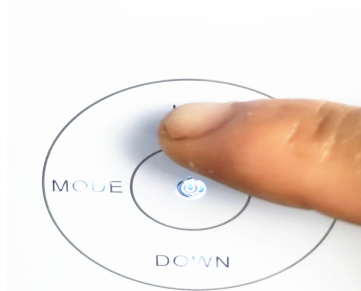

Step 3: press MODE button till "EVENT 1 PAUSE"  
show (continuous pause time)

Step 4: press UP button, adjust into 100

**D. Set up more  
work time**

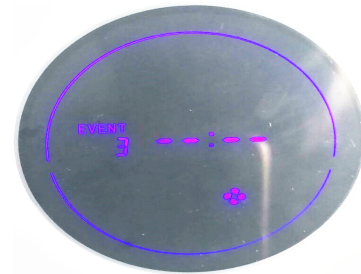
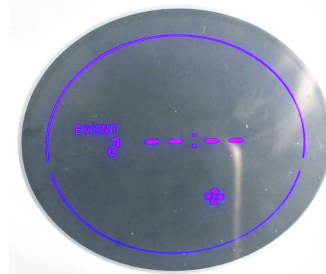

Step 1: press MODE button "EVENT 2"  
( means 2nd work time )  
if want more work time, you can set up  
with above steps

Step 2: press MODE button "EVENT 3"  
( means 3rd work time )

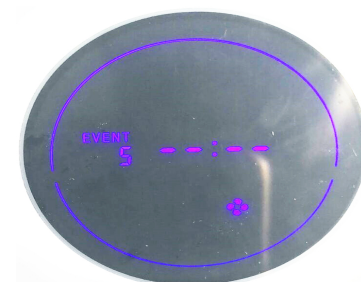
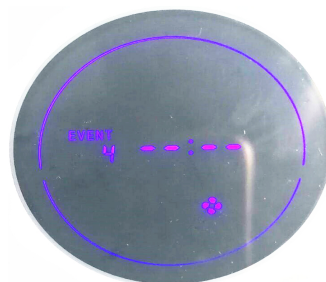

Step 3: press MODE button "EVENT 4"  
( means 4st work time )

Step 4: press MODE button "EVENT 5"  
( means 5st work time )



## 4. SHORTCUT FUNCTION

*This diffuser has some shortcut function, and Keep your setting in case someone else change it, like lock all button, stop working, reset, turn off light...*

**Lock all button** - Press SET button 5 seconds /  
Unlock all button by pressing 5s again

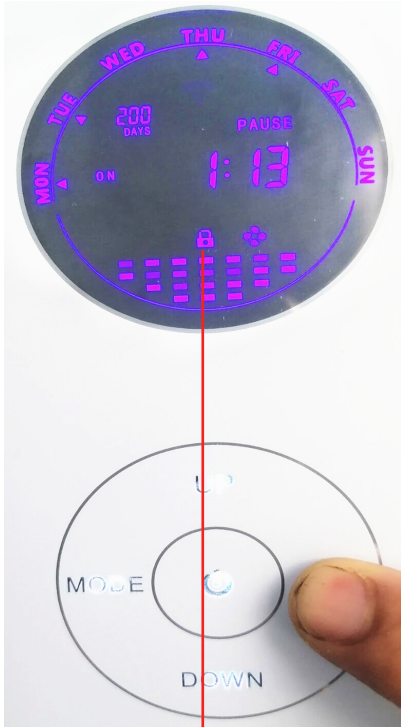

When this symbol show, it means you have locked all buttons; unlock by pressing SET button 5 seconds again.

**Stop Working** - Press central button quickly to turn off diffuser; press again to turn on it

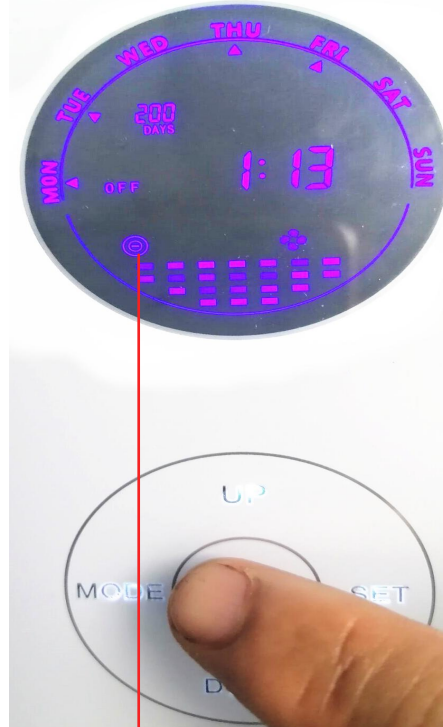

When this symbol show, it means diffuser turn off directly. turn on diffuser by pressing central button quickly

**Turn off oil light** - Press central button 5 seconds

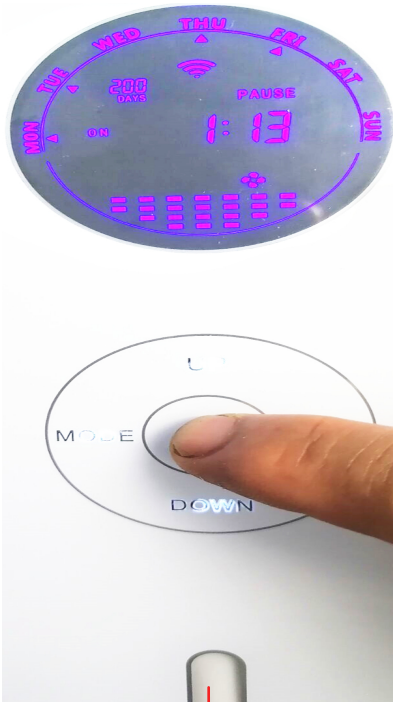

When no light for your oil-light, it means you have turn off light. you can turn on light by pressing 5 seconds again.

**Reset setting** - press MODE button 5 seconds

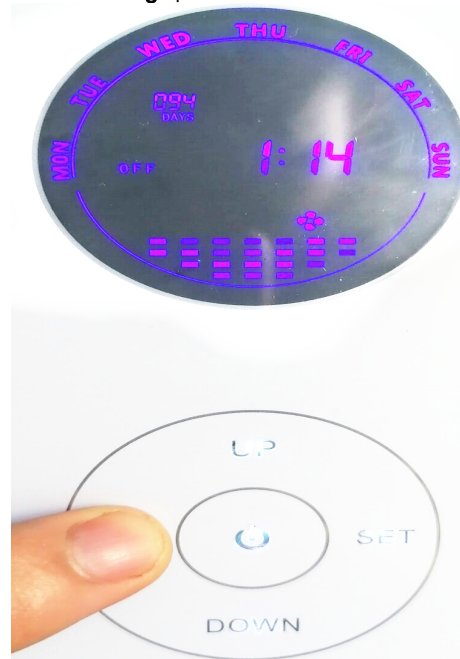

## 5 HOW TO CONNECT HVAC SYSTEM

Diffuser can stand alone, on wall, and connect hvac system. For each package, it included plastic tube (1.5m), joint connector, key, screw set (for wall assemble), adapter.

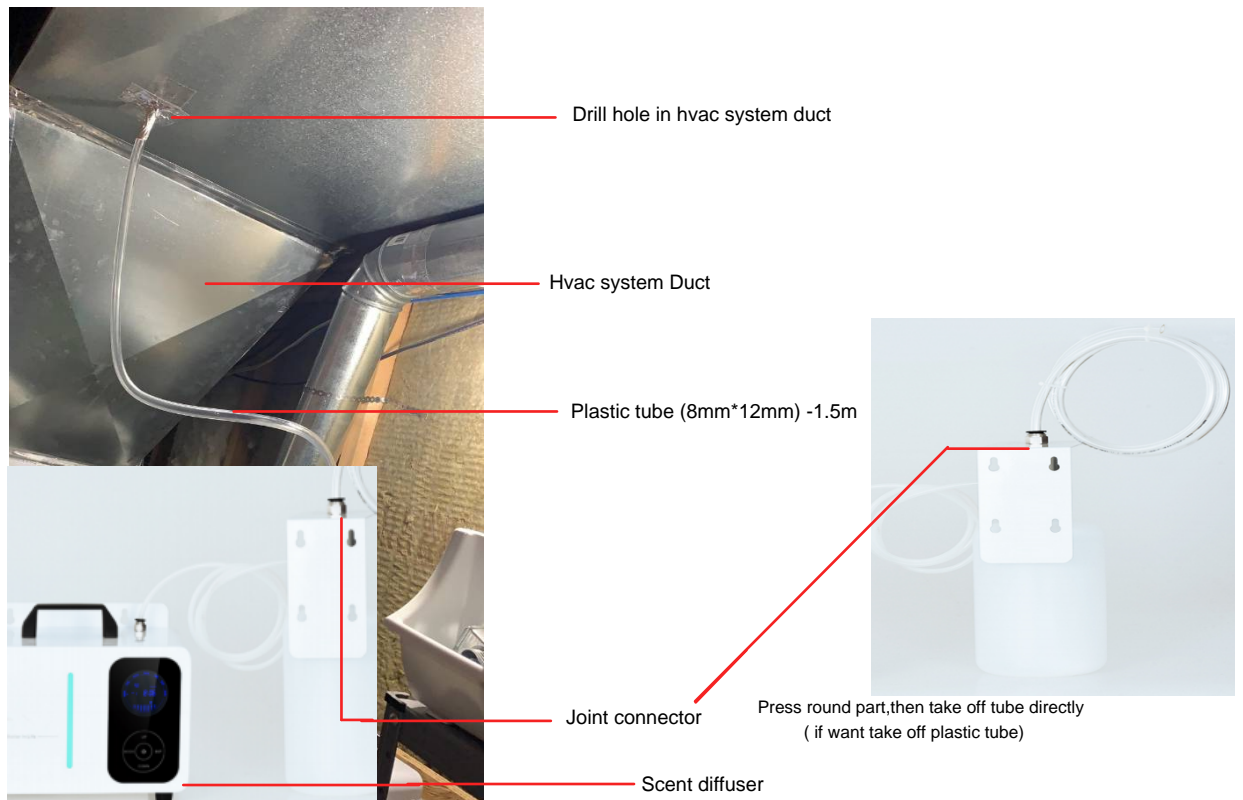

## 6 HOW TO CONNECT HVAC SYSTEM

For all diffuser, it needs do maintenance with alcohol to clean atomizer head after 30-60 days work, it will work perfect again. Detailed ways as follows:



### Step as follows:

1. Add much alcohol into bottle, no oil
2. Let machine work 20-30 min
3. Pour out alcohol and refill your oil

## 7 WHAT'S FUNCTION FOR SWITCH BUTTON

For this diffuser, when switch button is on, diffuser will work according to work time you set up; when switch button is off, diffuser will stop working, display no light

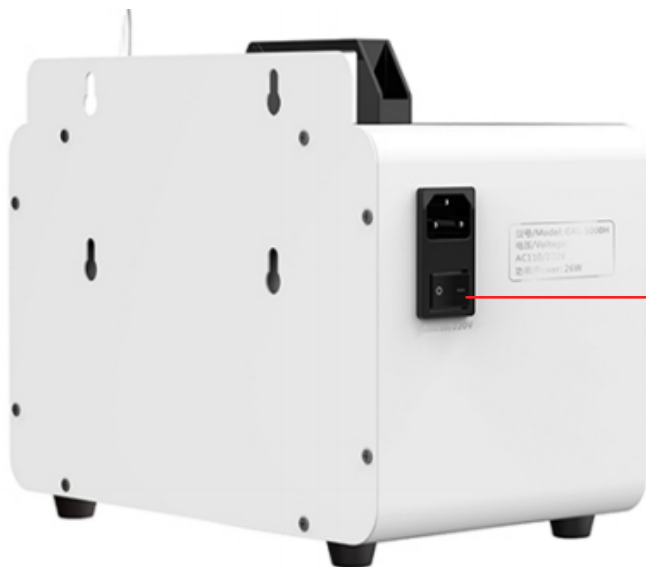

Diffuser Switch Button

When turn on, diffuser will work according to work time  
When turn off, Diffuser stop working, display no light

## 8 SOME INFORMATION FROM DISPLAY

Sometime when your diffuser no work. please check if it is same with following condition

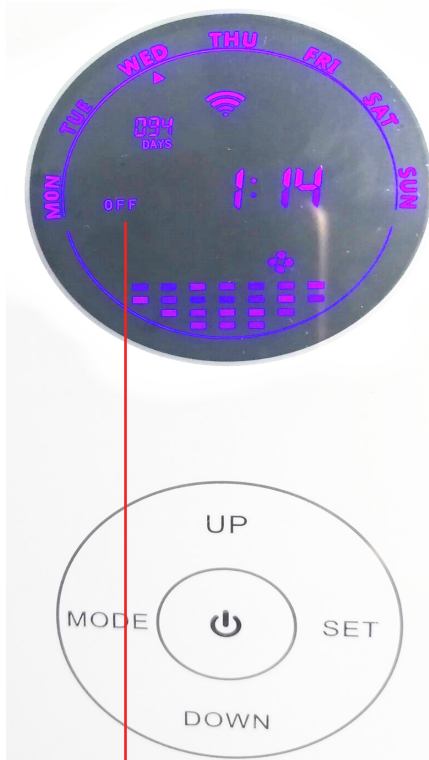

Show " OFF " here

-It means your country time is not within work time -

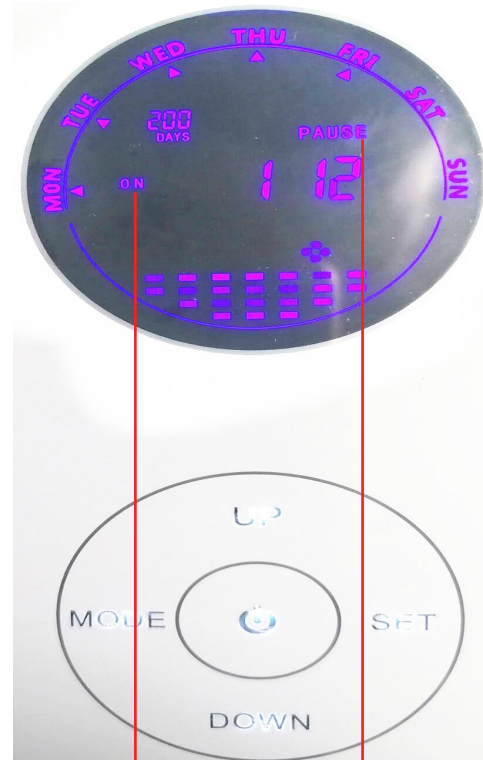

Show " ON" here    Show "PAUSE " here

- it means your diffuser only on pause condition now,  
it will start work again when pause time end(event 1 pause page)

## 9 OIL-LIGHT & OIL VOLUME

When you set up bottle volume / oil volume / oil consumption on display. the front light will change color according to oil volume left in bottle. when light change into red color.it means oil is not enough in bottle. Need refill Oil in time.

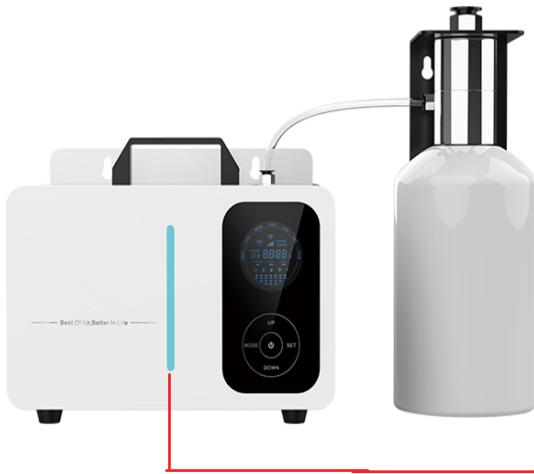

**Oil-light color & Oil volume**

Bottle volume	2000 ml	2000 ml	2000 ml
Oil volume in bottle	>50% ( 1000ml )	>25% ( 500 ml )	< 25% ( 500ml )
Light Color	GREEN	BLUE	RED

**Oil-Light**

**Note:**

1. When you refill oil, please do not forget to adjust oil volume on display .
2. Oil-light color does not affect diffuser working, Just show oil left in bottle

## 10 PROBLEM & SOLUTION

**A. Why our diffuser no work ? - ( No sounds from diffuser,Have much oil)**

1. please check your country time is within work time or not, if not,please adjust work time
2. please check your diffuser is on pause condition now. (show "ON" /" PAUSE" on display )

**B. Why our diffuser no work ? - ( Have sounds from diffuser,Have much oil )**

1. please tighten well bottle
2. please check atomizer core and slim tube fall down or not.
3. please block scent outlet 5 seconds when diffuser working,then remove finger fast.
4. Please do maintance with alcohol

**C. Why we can not change any button?**

because you have lockea all button by pressing SET button 5 seconds. please unlock by pressing SET button 5s again.

**D. Why diffuser display show less days for oil-last days even though have much oil in bottle?**

When you receive diffuser, you need set up bottle volume / oil volume / oil consumption.then our diffuser will calculate oil -last days; each time when you refill oil into bottle.need adjust oil volume on display.

**E. Why our oil Light change into red color?**

Oil-light will remind how much oil volume in bottle now,and remind user to refill oil in time; each time when you refill oil. please adjust oil volume on display by yourself.

Oil volume > 50% of bottle volume (800ml) - 400ML, light will be GREEN

Oil volume > 25% of bottle volume (800ml) - 200ML, light will be BLUE

Oil volume < 25% of bottle volume (800ml) - 200ML, light will be RED

**F. How long do we need do maintance for diffuser?**

It need do maintance about 30-60 days per time

**G. What's function for fan?**

It will help diffuser deliver scent into much area when fan is on.

**H. What's called for light on front of diffuser and function for light?**

That light is called oil-light. it will change color according to oil volume left in bottle. when you receive, need adjust bottle volume / oil volume / oil consumption. once you refill oil in next time.also need adjust oil volume on display.

**I. Which type oil diffuser will work?**

it only work with scent oil.essential oil. NO ANY WATER

**J. Why our diffuser can not produce scent after long time use ?**

please do maintance with alcolhol with above ways

**K. How much sounds when diffuser working?**

when diffuser working,sounds is about 40-45 db. we does not suggest to put in living room.

**L. Could we turn off fan when connecting hvac system ?**

because fan air outlet is not same with scent outlet. when connect hvac system,scent air will go into hvac system directly. No helpful for fan when diffuser connects hvac system.

**M. How much oil consumption for this diffuser ?**

Oil consumption is fixed. for this diffuser 5ml/h. when you set up work time. our diffuser will calculate oil last days directly. and show on display

**N. Why our diffuser can not work with our hvac system at same time ?**

because they have individual controller. if you want them work together. we suggest you can buy our air switch, it will let diffuser controlled by your hvac system.

**O. Why our diffuser leak oil when working ?**

1. please check your circle rubber broken or not.
2. bottle tighten well or not
3. check scent oil is waterless or not

- Better to contact us directly, we will settle problem directly -

**P. Why our diffuser can not produce scent out to hvac system when working?**

1. please check your plastic connect well with joint connector
2. check plastic tube keep upright. no oil in plastic tube
3. check if diffuser / hvac system is working or not

**Q. Why our oil volume does not change for long time working ?**

1. please check diffuser is working
2. please check atomizer core and slim tube loosen or not
3. please take off plastic tube (for connecting hvac), and show light on scent outlet when working.  
- Have scent fog, pls check plastic tube block or not  
- No scent fog, please check scent outlet have much air come out or not

**R. How to reset time for diffuser?**

Press MODE button on display 5 seconds. work time will reset into factory mode. It will work from 8:00 to 22:00 all days per week.

**S. What's setting time for my house ?**

It depends on your require about scent smell strong, you can try to adjust time according to your need. some other customer set: Work 100 seconds / pause 200 seconds, 10 hour / days

**T. Why we can smell scent from diffuser when receive new diffuser ?**

For all diffuser working perfectly, our company test all diffuser with oil before ship. so it is normal to smell scent.

**U. Why our diffuser works some seconds, then pause some seconds ?**

When we set up time for diffuser, it needs set up continuous work time (Event 1 Work) and continuous pause time (Event 1 PAUSE), if you want diffuser work more time. please change time into 300 seconds for work / 5s for pause.

**V. Do you sell part for key, plastic tube, bottle, Y connector...?**

Yes, you can buy any part of diffuser from us. please contact us if need.

**W. How Long last for my 1L oil ?**

It depends on your setting time, as follows:

1. Work 100 seconds, pause 200 seconds, 8 hour / days, it will last about 75 days
2. Work 50 seconds, pause 300 seconds, 8 hour / days, it will last about 175 days

**X. Why our diffuser can not cover so much area like ads said ?**

Coverage area is tested in our lab via hvac system. if not connect with hvac system, only about 3500 SQ.FT.

## 11 DIFFERENT DIFFUSER FOR YOUR SPACE



## 12 SCENT OIL WITH BIGGEST DISCOUNT

Need scent oil with low cost? Want biggest discount? Please contact us for latest news on oil.

More questions or problem? Please contact us directly, our after-service team will settle your problem ASAP.  
Email: [sale@kevinleoscent.com](mailto:sale@kevinleoscent.com)

--Kevinleo scent Team