

APPLICATION OPERATION MANUAL



SCAN TO DOWNLOAD APP

CHOOSE" SCENT TECH" APP TO DOWNLOAD

READ THE MANUAL CAREFULLY BEFORE USE AND KEEP IT PROPERLY

- This Diffuser Only come with Bluetooth Version, NO WIFI FUNCTION
- Please download our app: scent tech, on google player or apple store, or scan QR on following photos.
- The machine can be set for 5 groups for different working periods , it can set different working days, working times according to different requests and suit for different places.
- Diffuser only work when your country time is within work time. or not work
- For each work mode (Photos 5 below), time should be within 0:00-23:59, can not pass it, or system will not work. Also can not have same work time for each mode.
- If display button locked, that's because you locked on app. please unlock on Photos 13 below.

Any question? please contact us directly: sale@scent-master.com Whatsapp:+86 18158350716

1 INSTALLATION AND REGISTRATION INSTRUCTIONS

- 1) Scan the QR code and download the APP(**Scent Tech**) or download on google player or applestore.

Apple store



Google player



- 2) Open our app once completing download, then click" **BLUETOOTH**". **Must allow access for location and Nearby Devices. It will very important to connect BLUETOOTH signal.**

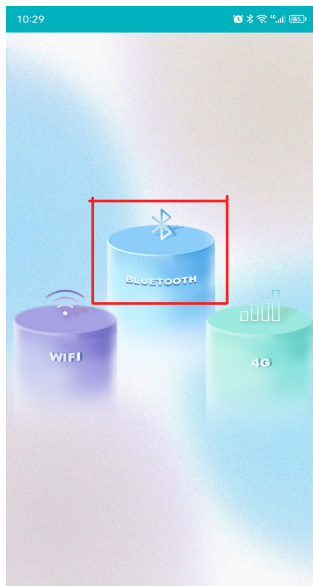

A. Click" Bluetooth"
(photos 1)

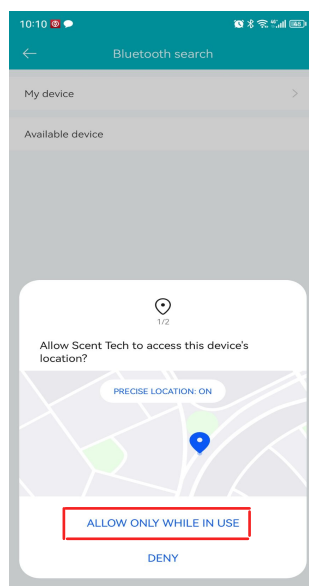

B.Click " Allow Only While In use"
(photos 2)



C. Click " Allow " for Nearby Devices access
(photos 3)

2 KNOW MORE ABOUT APP SETTING

Please click devices connected, you will see follow page

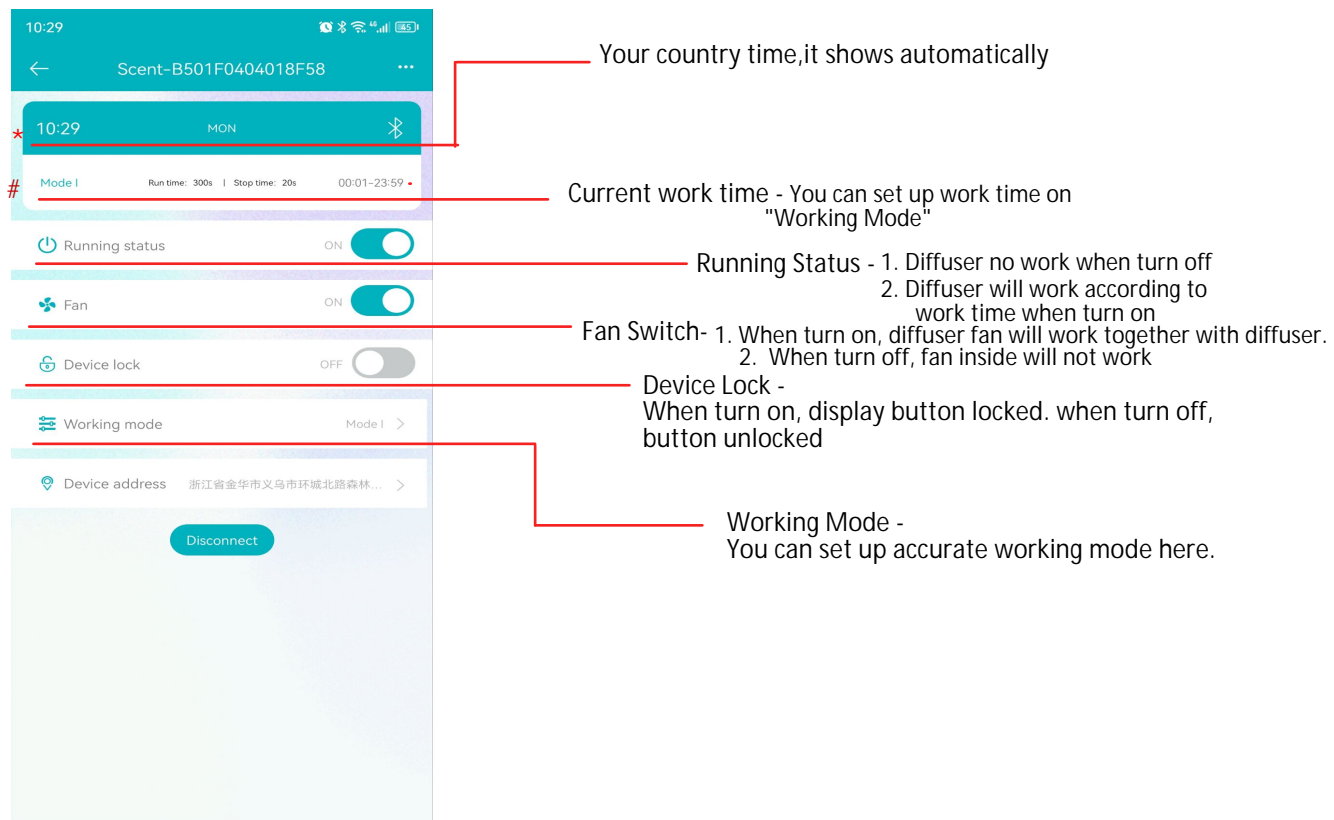

APP PAGE

(photos 4)

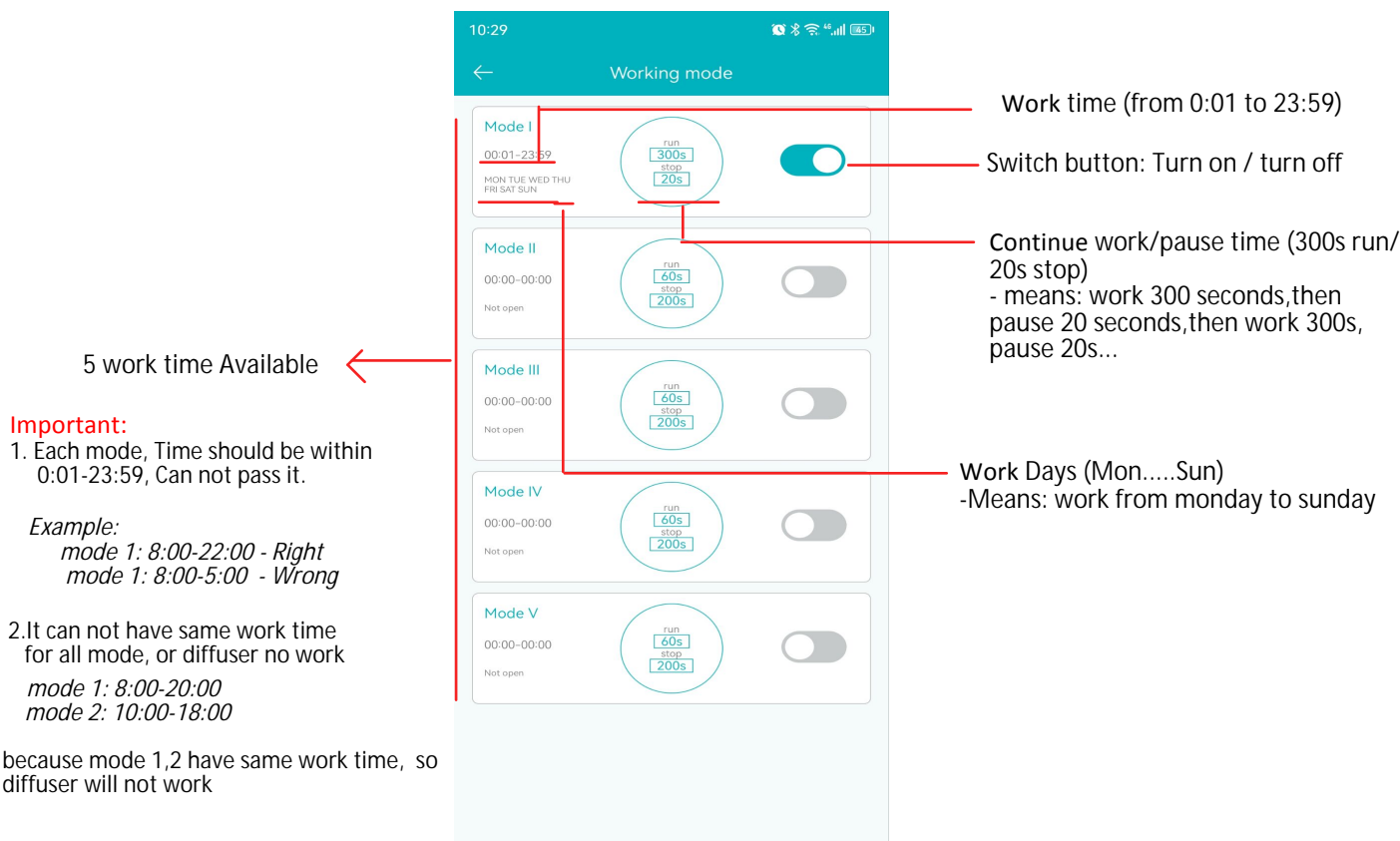

5 Work Time Available

(photos 5)

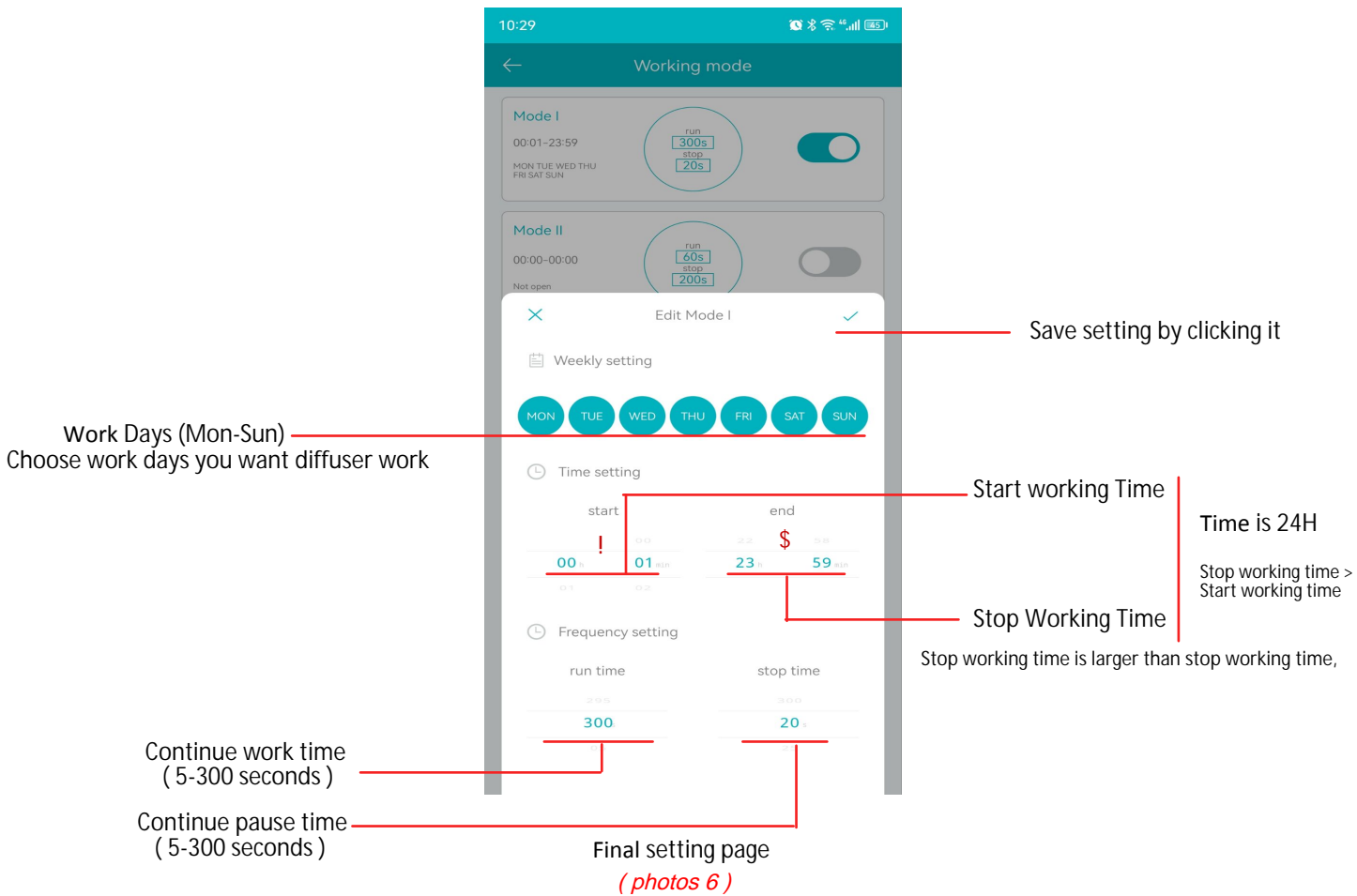

Most Important

Diffuser Only work when your country time(Remark * in photos 4) is within your work time (remark # in photos 4), or no work
 The number of start working time (Remark ! in photos 6) is less than number of stopping working time (Remark & in photos 6)

3.LET'S DO EXAMPLE

Example 1:

If you want diffuser work from 0:01 am to 23:59pm. all days per week. want continue work 300 seconds, then pause 20 seconds.

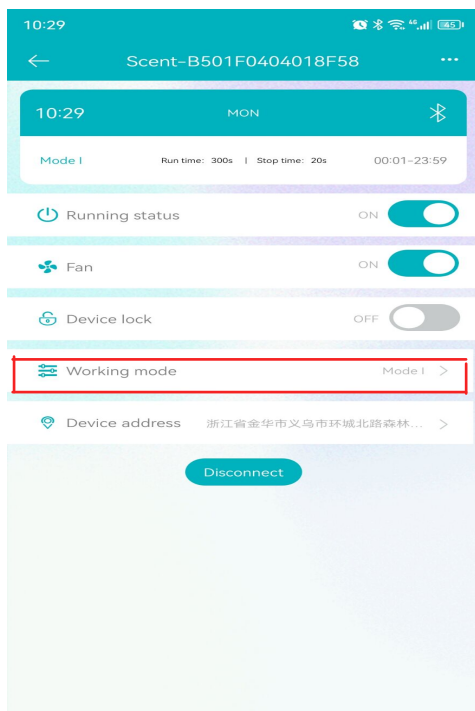

Step 1: Click Working mode (photos 7)

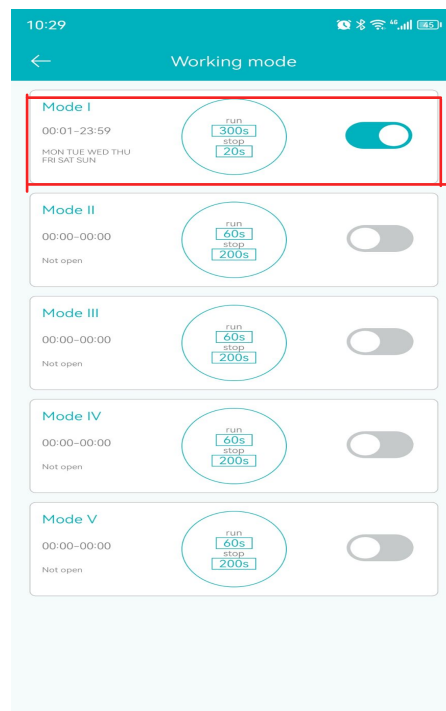

Step 2: Click mode 1 (photos 8)

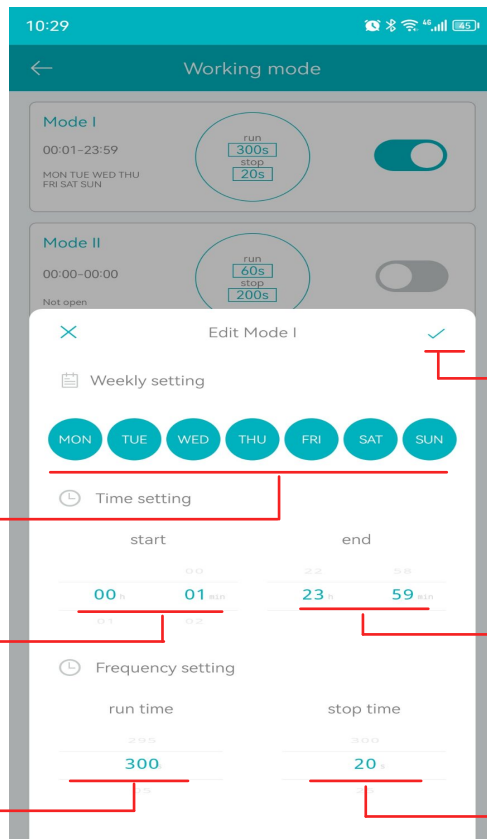

choose all days

Save it

(Start working time) change into 0:01

(Stop working time) change into 23:59

(Continue work time) change into 300

(Continue Pause time) change into 20

Step 3: Adjust like above photos

(photos 9)

Example 2:

If you want diffuser work from 9:00 am to 4:00 Am Next days, all days per week. want continue work 300 seconds, then pause 20 seconds.

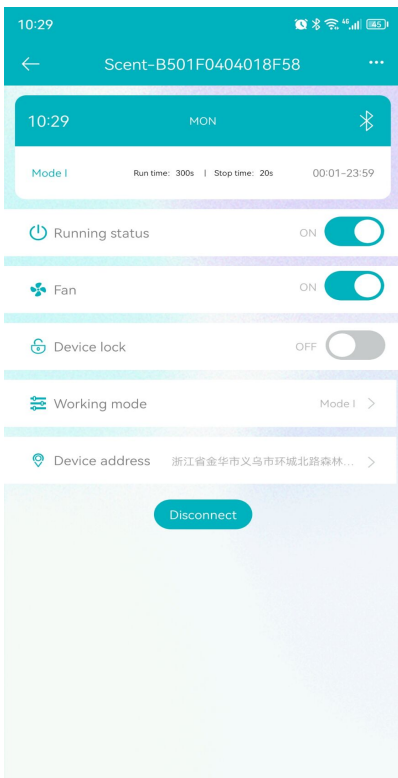

Step 1: Click Working mode
(photos 10)

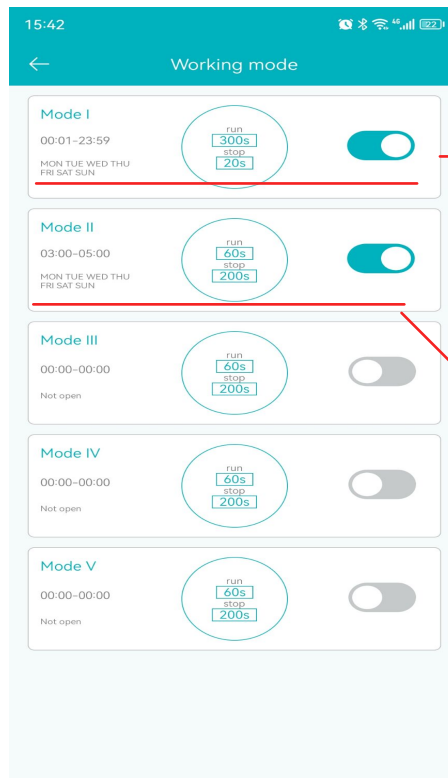

Step 2: Click Working mode
(photos 11)

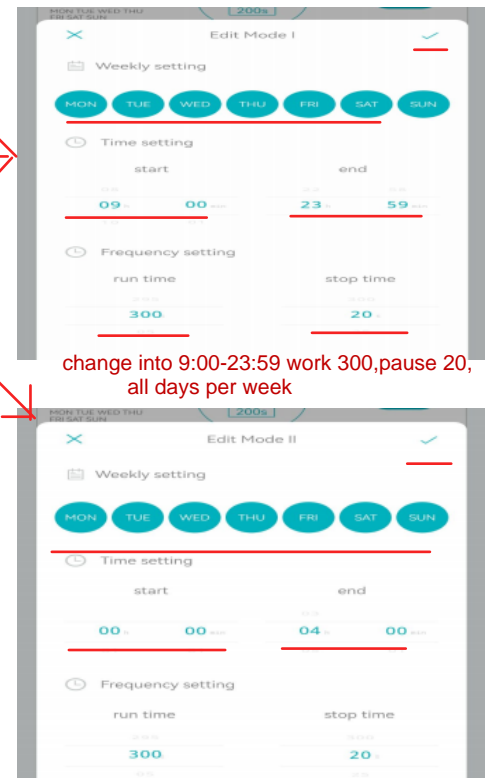

change into 9:00-23:59 work 300,pause 20, all days per week

change into 0:00-4:00 work 300,pause 20, all days per week

Step 3: Adjust work time for mode I, II
(photos 12)

Because 9:00-4:00am Next days, it has passed 23:59, so need change into 2 different work time:

1. mode 1: 9:00 - 23:59
2. mode 2: 0:00 - 4:00

4 PROBLEM & SOLUTION

A. Why can not successfully configure our app?

- Please check follows:

1. Have downloaded our app: Scent Tech
2. Allow all access for our app when opening our app
3. Keep your mobile Close to Diffuser

B. Why i can not press diffuser button?

Please unlock button on app here:

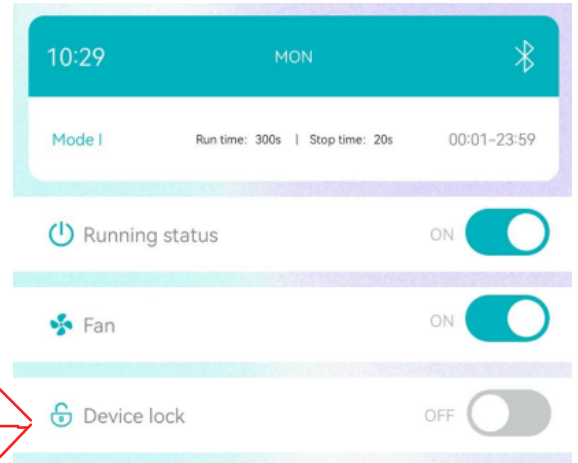

(photos 13)